

# Copthorne

## HOKIANGA



We would love to  
*see you here*  
2017 Conference Pack





# Welcome to Hokianga

The giant kauri trees of the Waipoua Kauri Forest act as sentinels for the undiscovered jewel of Northland's west coast, the historic Hokianga Harbour. The beauty here is unlike anywhere else in the country, remote, spiritual and relatively untouched. A land of contrasts, from lush kauri forest to sun kissed sand dunes, calm harbour waters to surf breaks on the sandbar, one visit to Hokianga and it will hold a special place in your heart forever. Perfect for your next business retreat or event.

Discover the areas rich history and beauty. Delegates can enjoy activities such as bush walks, charter fishing, land based fishing, boating, harbour cruises, swimming, sand boarding, golf, craft trails or taking it easy in this wonderful relaxed atmosphere.

## Location

One hour's drive from Kerikeri Airport or three hours north of Auckland arriving at the Hokianga will take your breath away. The headwaters of the Hokianga Harbour are framed by spectacular giant sand dunes and on the water's edge at Omapere, sits the Copthorne Hotel and Resort Hokianga. The famous sand dunes are only five minutes by boat and Waipoua Forest is 15 minutes drive away. This is an amazing place for a business event to experience a slice of kiwi paradise.





## The Hotel

Nestled at the entrance of Hokianga Harbour, the birthplace of Maoridom, Copthorne Hotel and Resort Hokianga offers a complete dedication to warm, hospitable service and attention to detail. From the grassy lawn, down to the beach, you'll find stunning views across the bay to the Hokianga's massive sand dunes. Add the region's subtropical micro climate and this is paradise.

The Copthorne Hotel and Resort Hokianga is endorsed with a Qualmark 4 star rating.

### **Guest Services**

- Bryers Room Restaurant
- Sands Bar
- 24 hour room service
- Solar heated swimming pool
- Wireless internet throughout the hotel
- Complimentary off street car parking
- Wharf and boat ramp
- Same day guest laundry
- Babysitting services
- Helicopter landing area





## Accommodation

Copthorne Hotel and Resort Hokianga has a total of 34 accommodation rooms from cosy standard rooms to sumptuous two bedroom suites with absolute seaviews. Relaxation and convenience are the signatures of this distinctive resort hotel.

### Standard Room

Stroll to the water's edge from your comfortable, well equipped room. Furnished in modern décor with a welcoming relaxed feel, some rooms include a small patio leading to the beautifully manicured garden.

### Superior Room

These elegantly designed rooms are located in the beachfront wing and offer stunning views of the Hokianga Harbour from either a balcony or patio. With modern décor, superior rooms offer a fresh, clean and welcoming feel.

### Two Bedroom Suite

Situated on the water's edge with breathtaking views of the harbour, suites are on the beachfront and only a short stroll to the golden sands of the harbour. These spacious suites have a separate lounge area, newly refurbished interiors giving an inviting appeal and full kitchen facilities.

### All rooms feature

Satellite television, wifi internet access, clock radio, refrigerator, tea and coffee facilities, direct dial telephone, ironing facilities and salon style hair dryer. Some rooms also include either a kitchenette or full kitchen facilities.

Check-in: 2.00pm

Check-out: 10.00am



## Conference Rooms

Copthorne Hotel and Resort Hokianga offers something totally different, an executive retreat on the waters edge of the remote and unspoilt Hokianga Harbour. There are several entrances to the ground level conference facilities and for those needing additional space, a 15m x 9m marquee is available for hire that can seat up to 120.

### Te Puna

This self contained conference room opens out to the inspiring view of the Hokianga Harbour. With 144m<sup>2</sup> of floor space, this spacious room has natural light, spotlights, chandeliers and beautiful rimu timber finishes. Located in the main building of the hotel Te Puna has the capacity to cater for up to 100 theatre style with a number of breakout areas located throughout the facility. Bi-fold doors to the restaurant can be opened allowing an increase in capacity for larger meetings or events.





# Capacities

Capacities	Area Sqm	Ceiling Height							
Te Puna 1	144	2.60m	80	40	50	50	30	30	35
Te Puna 1 & 2	264	2.60m	200	64	120	100	-	-	84

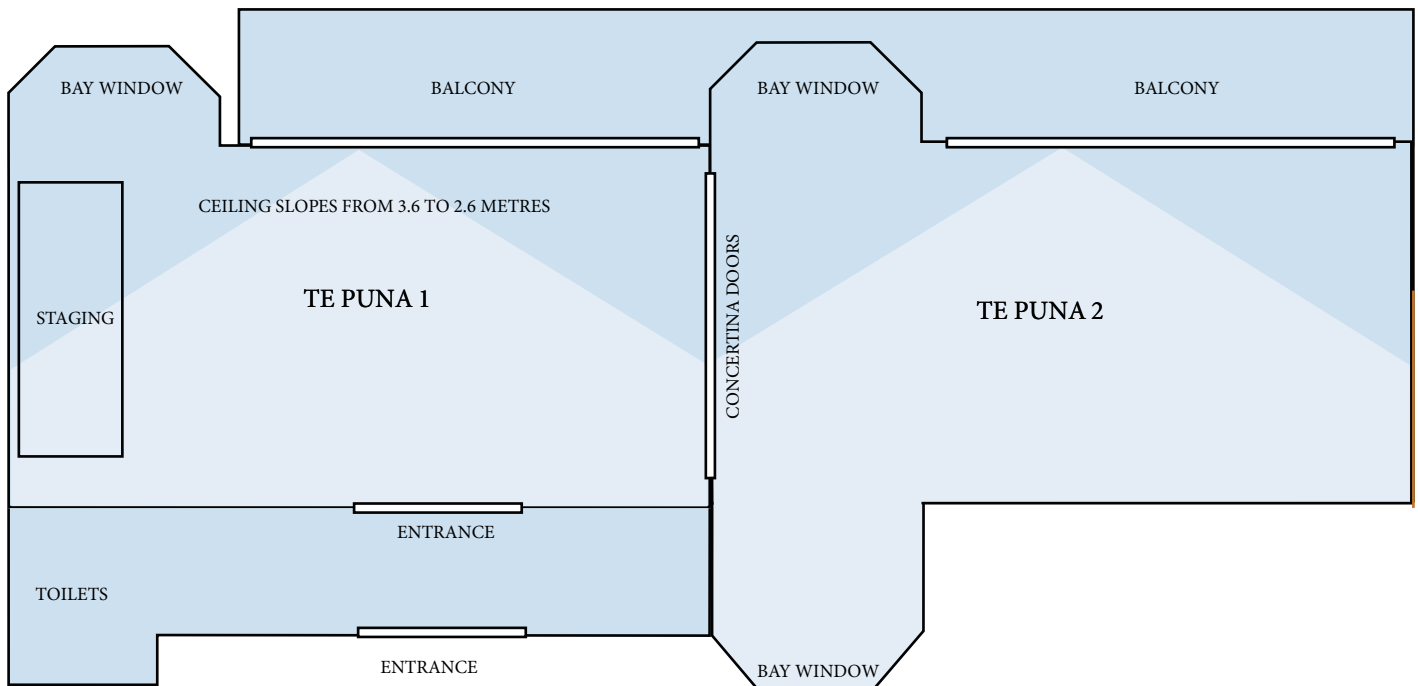



# Conference Essentials

## Day Delegate Packages

**Full Day Delegate Package**  
 NZ\$58.00 per person per day includes:

Plenary venue hire  
 Morning tea  
 Buffet lunch  
 Afternoon tea  
 Projection screen  
 Whiteboard with markers  
 Flipchart with markers  
 Notepads, pens, iced water and mints

**Half Day Delegate Package**  
 NZ\$49.00 per person per day includes:

Plenary venue hire  
 Morning or afternoon tea  
 Buffet lunch  
 Projection screen  
 Whiteboard with markers  
 Flipchart with markers  
 Notepads, pens, iced water and mints

Delegate packages are available for booking of 20 delegates or more and are inclusive of 15% GST.

## Audio Visual Equipment

Equipment	Cost per day	Equipment	Cost per day
First whiteboard	Complimentary	TV/DVD	From NZ\$50.00
Projection screen	Complimentary	Data projector	NZ\$100.00
First flipcharts	NZ\$20.00	Lectern	Complimentary
Flipcharts	NZ\$20.00	Sound system with microphone	NZ\$400.00

*We work closely with a local audiovisual supplier and can arrange additional equipment based on your specific requirements.*

*Conference room wireless internet access for multiple users is available for 18 hours or 1GB, whichever comes first, is available at a rate of \$75.00.*

*All the above pricing is inclusive of 15% GST unless otherwise stated.*



## Food & Beverage

### Catering

When planning your catering we offer several different solutions and can tailor menus to suit dietary requirements and your budget. Refreshments are served in the conference room, however, a breakout area can be arranged if preferred. Dinner themes are a great way to make a statement or create a memorable evening and our conference team can supply detailed menus and theme ideas.

<b>Arrival tea and coffee</b>	NZ\$ 4.00
<b>Morning or afternoon tea</b>	From NZ\$ 9.00
<b>Lunch</b>	From NZ\$25.00
<b>Canapés</b>	From NZ\$10.00
<b>Buffet dinners</b>	From NZ\$40.00
<b>Plated dinners</b>	From NZ\$45.00

All prices are per person and include 15% GST.

### Bryers Room Restaurant

Bryers Room Restaurant is the original dining room of the 112 year old Bryers Homestead. The high kauri ceilings, period furniture and expansive deck overlooking the entrance to the harbour provide a sense of grandeur, charm and ambience for your dining experience. Enjoy an excellent à la carte menu sampling fresh, locally grown produce along with local indigenous flavours. Welcoming and memorable, the Bryers Room Restaurant is open daily for breakfast and dinner.

### Sands Bar

Sands bar offers expansive decks and stunning views in a casual, relaxed atmosphere. From the informal lounge to the sunny conservatory delegates can gather for a friendly game of pool or relax beside a welcoming fire on those cool winter evenings.





## Activities & Attractions

From team building to partner and touring programs, our expert conference team will enhance your whole meeting experience with our innovative ideas and impeccable service tailored to suit your group and budget.

Hokianga offers a wide range of activities right on your doorstep. Game fishing, kayaking, sand-boarding, beach treks, art galleries and coastal bush walks are just a few of the many activities available. Indulge in the local culture with the Ngapuhi Tribe on a waka tour or take a boat trip across the harbour to the 300m high sand dunes. Well maintained tracks give access to the famous giant trees Tane Mahuta (1,400 years old) and Te Matua Ngahere (2,000 years old). Enjoy a Footprints encounter through the Waipoua Forest with a local Maori guide, described by the Lonely Planet Code Green as an experience of a lifetime.

Many quaint villages dot the Hokianga including the twin settlement of Omapere and Opononi. Visit Rawene, New Zealand's third oldest European settlement, to see the historic Clendon House and the recently completed mangrove walk. Kohukohu is an historic timber mill town, while second oldest European settlement Horeke was an historic ship building town. Nearby Mangungu Mission House is the site of the second signing of the Treaty of Waitangi.



## For Assistance

### **Copthorne Hotel & Resort, Hokianga**

State Highway 12, Omapere  
Hokianga, New Zealand 0473

Conference and Events Manager: Marina Stewart  
Telephone: +64 9 405 8737 Extension 3  
Email: [events@omapere.co.nz](mailto:events@omapere.co.nz)

### **Millennium Hotels and Resorts National New Zealand Sales Office**

National Conference Co-ordinator: Maxine Hale  
Toll Free within New Zealand: 0800 4 MEETINGS (0800 4 633 846)  
Telephone: +64 3 367 3302  
Email: [meetings@millenniumhotels.com](mailto:meetings@millenniumhotels.com)

### **Millennium Hotels and Resorts National Australian Sales Office**

Conference and Incentives Business Development Manager: Tania Barnes  
Telephone: +61 4 2117 3325  
Email: [tania.barnes@millenniumhotels.com](mailto:tania.barnes@millenniumhotels.com)

[www.meetingsnz.co.nz](http://www.meetingsnz.co.nz)